

- 1 THIS IS A C.A.D. PRODUCED DRAWING AND SHOULD NOT BE AMENDED BY HAND
- 2 All dimensions in millimetres unless otherwise stated
- 3 Reproduced from Ordnance Survey under Licence No: 100023509 (2010) Crown Copyright Reserved.
- 4 Any errors or omissions to be reported to the Designer
- 5 Do not scale off this drawing - all measurements to be checked on site.

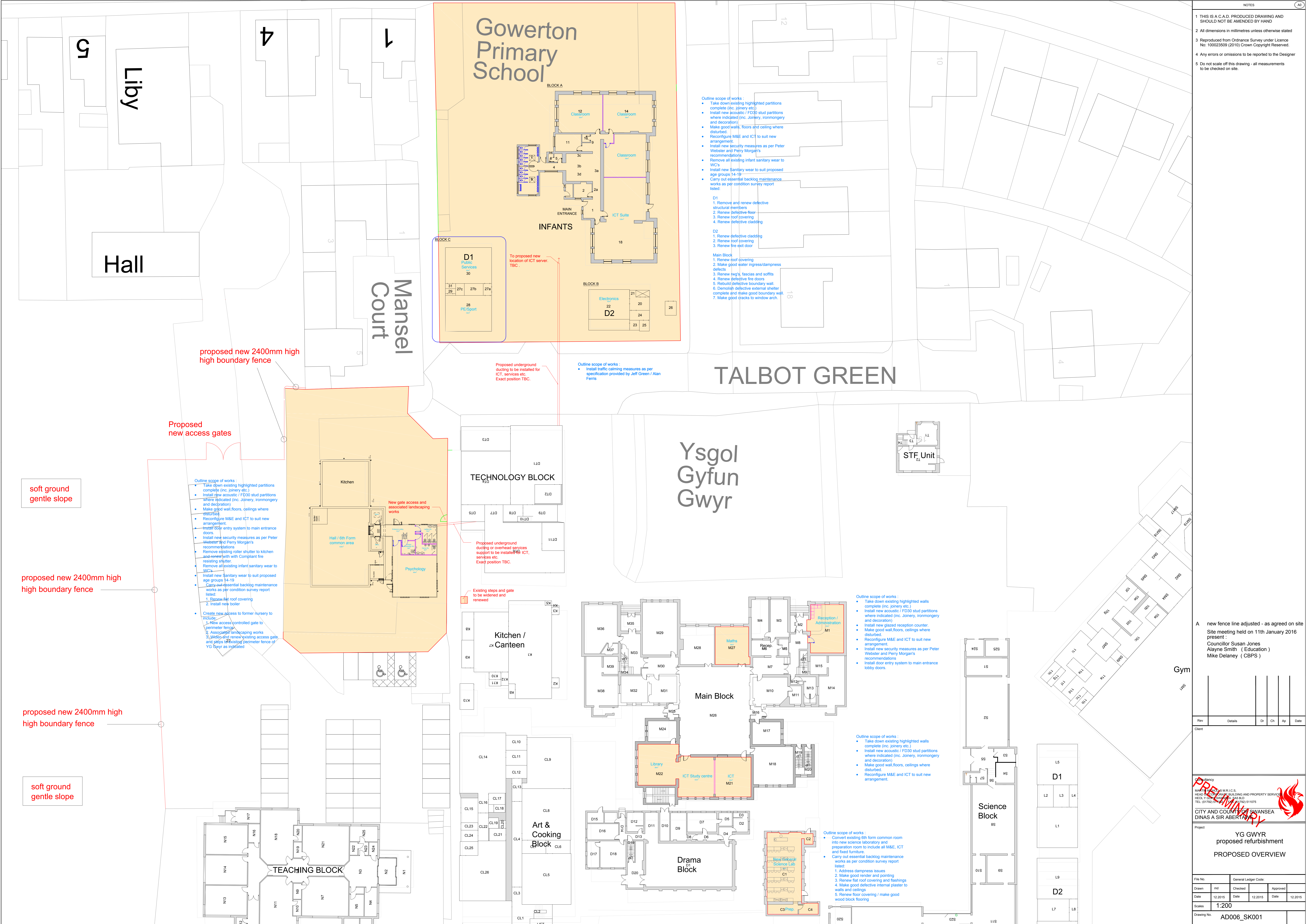

Gowerton Primary School

- Outline scope of works :
- Take down existing highlighted partitions complete (inc. joinery etc.)
 - Install new acoustic / FD30 stud partitions where indicated (inc. Joinery, ironmongery and decoration)
 - Make good walls, floors and ceiling where disturbed
 - Reconfigure M&E and ICT to suit new arrangement
 - Install new security measures as per Peter Webster and Perry Morgan's recommendations
 - Remove all existing infant sanitary wear to WC's
 - Install new Sanitary wear to suit proposed age groups 14-19
 - Carry out essential backlog maintenance works as per condition survey report listed:

- D1
- Remove and renew defective structural members
 - Renew defective floor
 - Renew roof covering
 - Renew defective cladding
- D2
- Renew defective cladding
 - Renew roof covering
 - Renew fire exit door

- Main Block
- Renew roof covering
 - Make good water ingress/dampness defects
 - Renew roof fascias and soffits
 - Renew defective fire doors
 - Rebuild defective boundary wall
 - Demolish defective external shelter complete and make good boundary wall
 - Make good cracks to window arch

- Outline scope of works :
- Install traffic calming measures as per specification provided by Jeff Green / Alan Ferns

- Outline scope of works :
- Take down existing highlighted partitions complete (inc. joinery etc.)
 - Install new acoustic / FD30 stud partitions where indicated (inc. Joinery, ironmongery and decoration)
 - Make good wall/floors, ceilings where disturbed
 - Reconfigure M&E and ICT to suit new arrangement
 - Install door entry system to main entrance doors
 - Install new security measures as per Peter Webster and Perry Morgan's recommendations
 - Remove existing roller shutter to kitchen and re-open with compliant fire resisting shutter
 - Remove all existing infant sanitary wear to WC's
 - Install new Sanitary wear to suit proposed age groups 14-19
 - Carry out essential backlog maintenance works as per condition survey report listed:
- Renew roof covering
 - Install new boiler
- Create new access to former nursery to include:
- New access controlled gate to perimeter fence
 - Associated landscaping works
 - Demolish and renew existing access gate and add 2400mm high perimeter fence of YG Gwyr as indicated

proposed new 2400mm high high boundary fence

Proposed new access gates

soft ground gentle slope

proposed new 2400mm high high boundary fence

proposed new 2400mm high high boundary fence

soft ground gentle slope

A new fence line adjusted - as agreed on site
 Site meeting held on 11th January 2016
 present :
 Councillor Susan Jones
 Ailayne Smith (Education)
 Mike Delaney (CBPS)

Rev	Details	Dr	Ch	App	Date

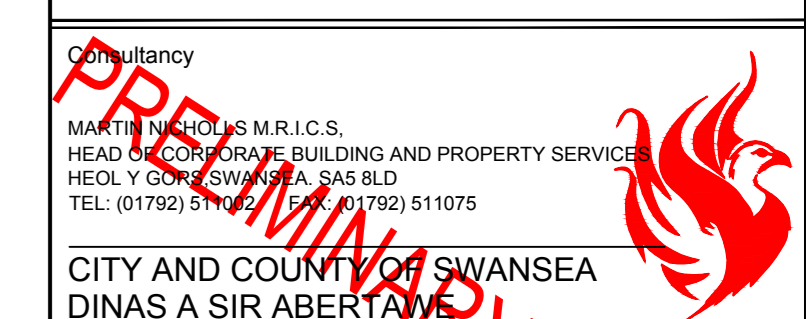

YG GWYR proposed refurbishment PROPOSED OVERVIEW

File No:	General Ledger Code:	
Drawn: imd	Checked:	Approved:
Date: 12.2015	Date: 12.2015	Date: 12.2015
Scales: 1:200		
Drawing No: AD006_SK001		